



BEARING UNITS



FLANGE CARTRIDGE UNITS - Metric Pilot Diameter

HCFC 200 Series

Normal Duty

Eccentric Collar Locking

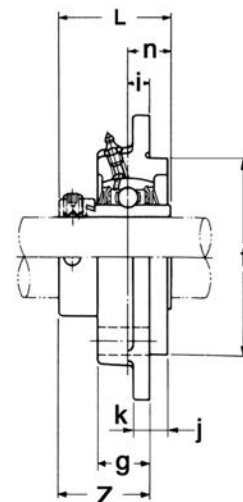
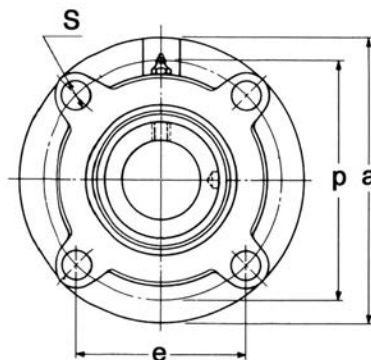

Unit No.	Shaft Dia.		Dimensions inch / mm												Bolt Size	Bearing No.	Housing No.	Weight Lbs kg
	In.	mm	a	p	e	i	s	j	k	g	f	z	L	n				
HCFC 201-8	1/2															HC 201-8		
202-10	5/8	20	3-15/16	78	2-1/64	13/32	15/32	13/64	9/32	13/16	62	1-1/8	1.713	0.669	3/8	202-10	FC204	1.76
204			100.0		51.2	10.3	11.9	5.2	7.1	20.6		28.6	43.5	17.0	M10	204		0.80
204-12	3/4															204-12		
HCFC 205		25														HC 205		
205-14	7/8		4-17/32	90	2-1/2	13/32	15/32	15/64	9/32	13/16	70	1-11/64	1.744	0.685	3/8	205-14	FC205	2.2
205-15	15/16		115.1		63.5	10.3	11.9	6.0	7.1	20.6		29.8	44.3	17.4	M10	205-15		1.00
205-16	1															205-16		
HCFC 206		30														HC 206		
206-17	1-1/16		4-29/32	100	2-25/32	13/32	15/32	5/16	5/16	29/32	80	1-17/64	1.902	0.717	3/8	206-17	FC206	2.86
206-18	1-1/8		124.6		70.6	10.3	11.9	7.9	7.9	23.0		32.1	48.3	18.2	M10	206-18		1.30
206-19	1-3/16															206-19		
206-20	1-1/4S															206-20		
HCFC 207		35														HC 207		
207-20	1-1/4		5-5/16	110	3-1/16	7/16	9/16	5/16	11/32	1-1/32	90	1-7/16	2.012	0.740	7/16	207-20	FC207	3.52
207-21	1-5/16		134.9		77.8	11.1	14.3	7.9	8.7	26.2		36.5	51.1	18.8	M12	207-21		1.60
207-22	1-3/8															207-22		
207-23	1-7/16															207-23		
HCFC 208		40														HC 208		
208-24	1-1/2		5-45/64	120	3-21/64	7/16	9/16	13/32	11/32	1-1/32	100	27/32	2.217	0.843	7/16	208-24	FC208	4.62
208-25	1-9/16		144.9		84.5	11.1	14.3	10.3	8.7	26.2		21.4	56.3	21.4	M12	208-25		2.10
HCFC 209		45														HC 209		
209-26	1-5/8		6-5/16	132	3-43/64	13/32	5/8	15/32	9/16	1-1/32	105	1-37/64	2.217	0.843	1/2	209-26	FC209	5.94
209-27	1-11/16		160.3		93.3	10.3	15.9	11.9	14.3	26.2		40.1	56.3	21.4	M14	209-27		2.70
209-28	1-3/4															209-28		
HCFC 210		50														HC 210		
210-30	1-7/8		6-1/2	138	3-27/32	13/32	5/8	15/32	9/16	1-3/32	110	1-11/16	2.469	0.969	1/2	210-30	FC210	6.82
210-31	1-15/16		165.1		97.6	10.3	15.9	11.9	14.3	27.8		42.9	62.7	24.6	M14	210-31		3.10
210-32	2S															210-32		
HCFC 211		55														HC 211		
211-32	2		7-9/32	150	4-3/16	1/2	3/4	15/32	19/32	1-1/4	125	1-53/64	2.811	1.091	5/8	211-32	FC211	9.24
211-34	2-1/8		184.9		106.4	12.7	19.1	11.9	15.1	31.8		46.4	71.4	27.7	M16	211-34		4.20
211-35	2-3/16															211-35		
HCFC 212		60														HC 212		
212-36	2-1/4		7-11/16	160	4-1/2	21/32	3/4	15/32	19/32	1-13/32	135	2-15/64	3.059	1.217	5/8	212-36	FC212	11.66
212-37	2-5/16		195.3		114.3	16.7	19.1	11.9	15.1	35.7		56.8	77.4	30.9	M16	212-37		5.30
212-38	2-3/8															212-38		
212-39	2-7/16															212-39		